

snow eater

Looking up from inside

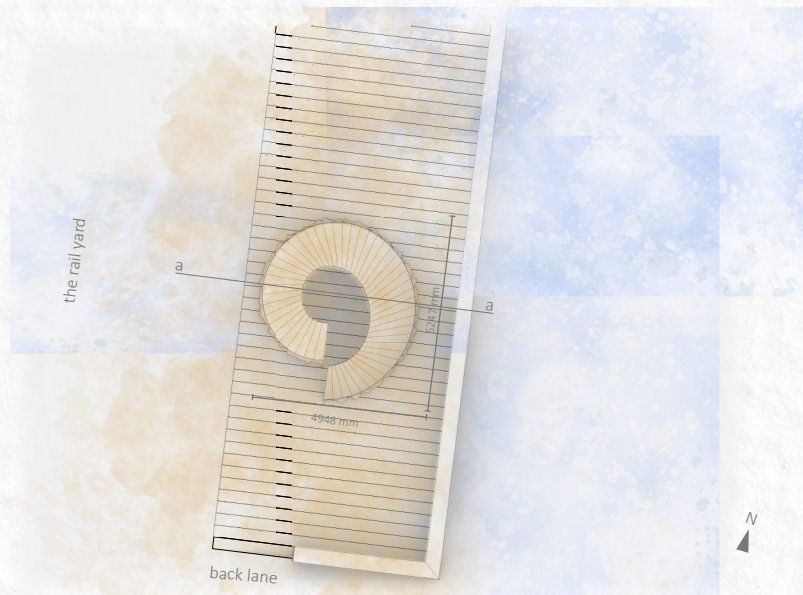

Plan



Typical Detail (NTS)

3/4" plywood panel
8 mm flexible plywood
Hanging curtain cord w/ hook

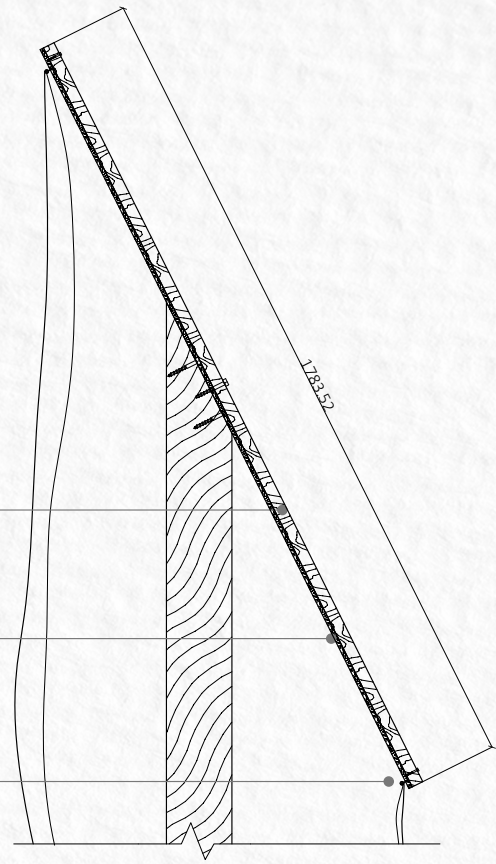

Section A

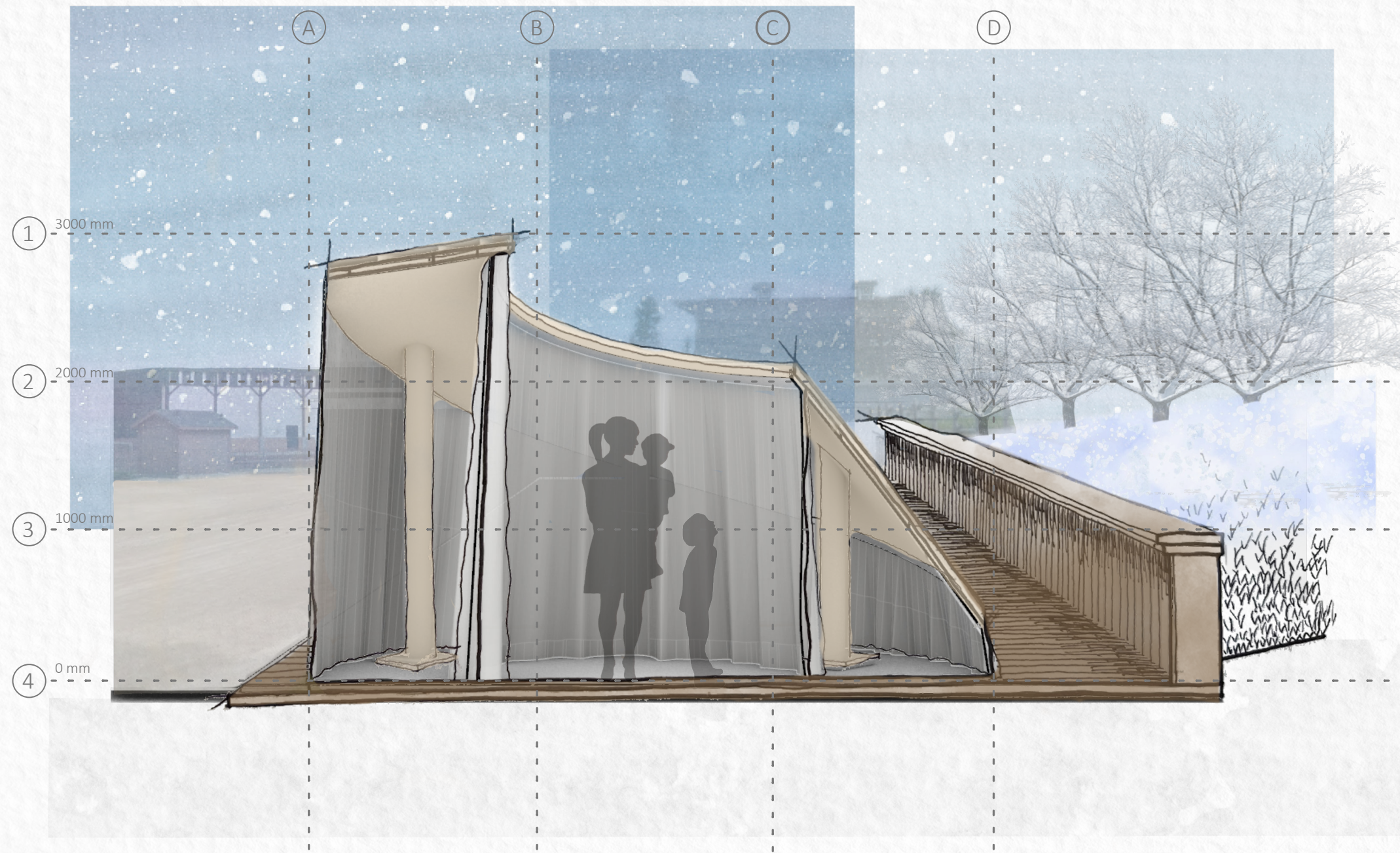

120" L sheer white drapes (soaked then frozen)
4"x4" wood post
2 mm Steel L Right Angle Bracket
1" plywood
2"x4" sleepers

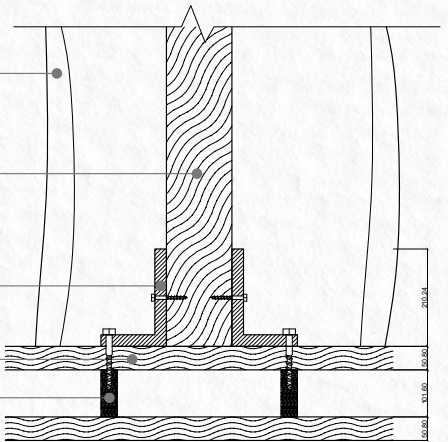

Materials Schedule

Material	Unit	\$/unit	Sum
2x4 wood sleeper	18	7.60	136.8
1" plywood planks	32	13.98	41.94
Steel L brackets	10	4.39	40.39
Wood Posts	5	23.38	116.90
120" L sheer white drapes	6	38.99	233.94
Hanging curtain cord w/ hook	4	15.99	63.96
8 mm flexible plywood sheets	12	79.99	959.88
3/4" mm plywood panels (x50)	6	32.44	194.64
10 x 2.5" wood screws	200	0.15	30.00
TOTAL			1818.45